



With the key word being innovation and quality, BIHUI develops tools for professional installers and strives to focus on the design, manufacture and distribution of tiling and construction tools for safe handling, transportation and cutting of large format tiles as well as installing all kinds of ceramic & porcelain tiles.



LARGE FORMAT TOOLS	4-10
TILERS MULTI-FUNCTION WORKBENCH	11
TILE BEATER & SUCTION CUP	12-17
NOTCHED TROWEL	18-21
CLEANING TOOLS	22-23
TILING TOOLS	24-25
KNEE PADS	26
LEVELLING SYSTEM	27-30
TILE SPACER	31
TILE CUTTER	32-34
LASER LEVEL	35
MIXING	36-38
VACUUM CLEANER	39
CONCRETE GRINDER & CUP WHEELS	40-42
ANGLE GRINDER	43
DIAMOND TOOLS	44-57
PROMOTIONAL ITEMS	58
TRADE FAIRS	59
MERCHANDISING	60-63

LARGE FORMAT TOOLS



Classic Carrier System

- ▲ Max. Capacity: 3.2m x 1.6m
- ▲ Max. Lifting Capacity: **130kg (286 lbs)**
- ▲ 2pcs longitudinal rails with soft grip handles
- ▲ Adjustable length: 1700-3200 mm
- ▲ Includes 4 vacuum suction cup and 6 aluminum suction cup
- ▲ Robust and stable plate for large-format plates

Art.No	Size
LFCSV4	3.2x1.6M



Trade Carrier System

- ▲ Max. Capacity: 3.2m x 1.6m
- ▲ Max. Lifting Capacity: **200Kg (441 lbs)**
- ▲ Includes 6 or 8 vacuum suction cup with brass handle
- ▲ Featured with four soft grip handle on the top and four extension handle on the side for extra force
- ▲ Lightweight and easy to transport large format tiles thanks to the adjustable extension bar so to adapt to tiles sizes to handle them

Art.No	Size
LFCSV6	6xSCVG8
LFCSV8	8xSCVM8
LFCSBAG	200x48x23cm

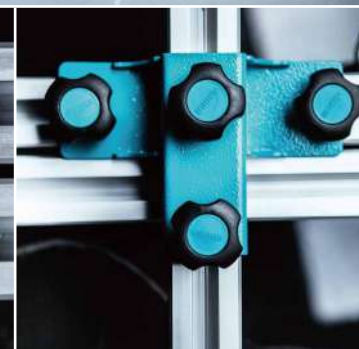
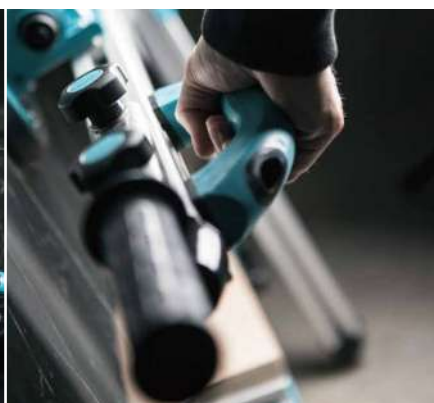
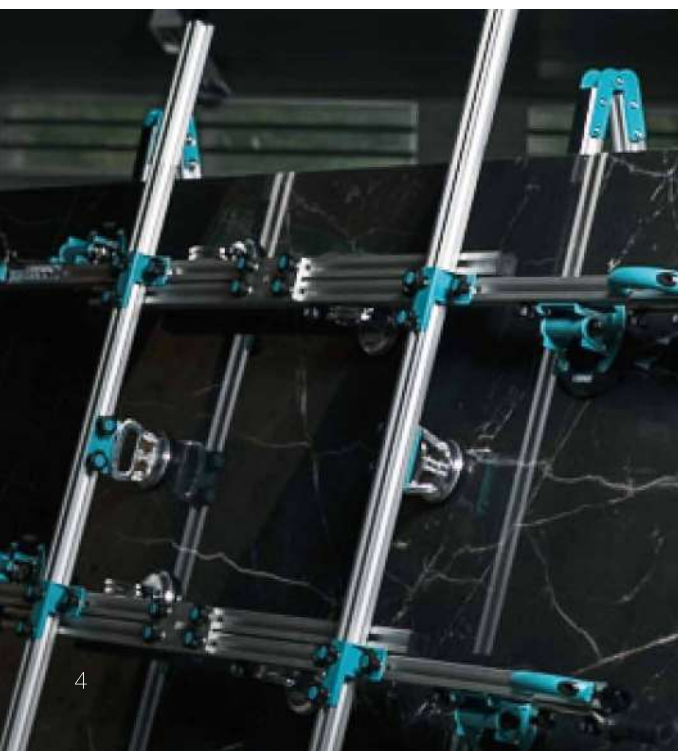



Working Bench

- ▲ A lightweight, robust and stable workbench for large-format tiles, enabling cutting / drilling without risk of damaging the work surface
- ▲ Easily assembled for transport and storage and can be mounted together with additional tables for increased work surfaces
- ▲ Foldable legs and storage hooks for cutting system
- ▲ Height: 800mm
- ▲ Width: 1400mm
- ▲ Length: 1800mm
- ▲ Max. Load: **200kg(441 lbs)**
- ▲ Suitable for tile size upto 3.6 x 1.4M after 2 tables joint together

Art.No	Size
LFWB	1.8x1.4M

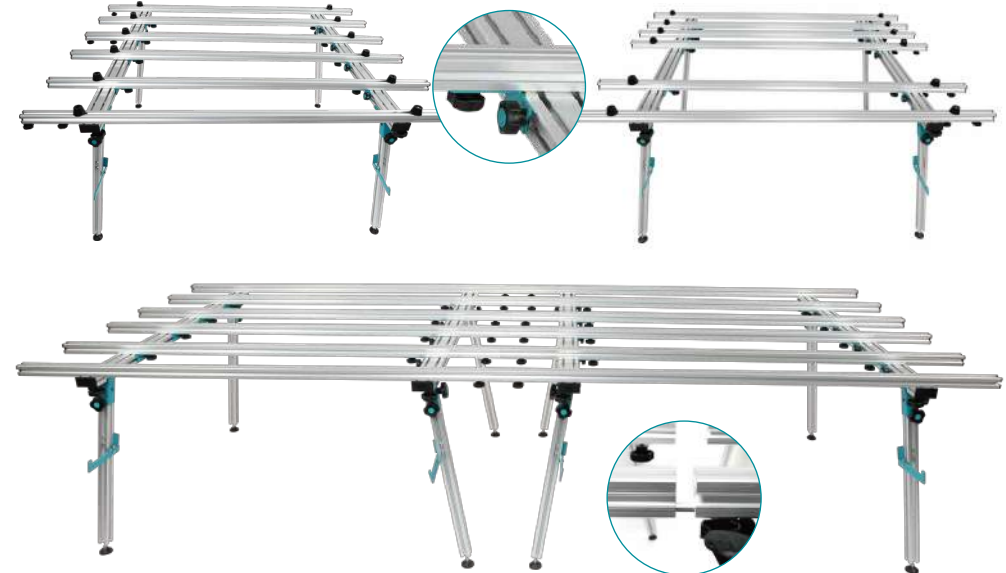



Manual Cutting System

- ▲ Compatible rails with the electric cutting system. **Two systems, One rail**
- ▲ Suitable for cutting tiles size upto 3.2M
- ▲ Rails in size 1.4M and 0.8M for different tile length
- ▲ Cutting depth 6-8mm
- ▲ 1 x Carbide wheel assembled
- ▲ 1 x Spare wheel in box
- ▲ 3 x Aluminium suction cup
- ▲ 2 x F clamp
- ▲ 1 x Breaking clamp
- ▲ 1 x Breaking nipper
- ▲ Packed in plastic case and tool bag



Heavy Duty Tile Breaking Clamp

- ▲ For breaking large format tile upto 15mm

Art.No	Description
LFMCS	3.2M - 6mm
LFMC	Cutting Head
LFRS	Rail System
LFTBD	Max. 15mm



Electric Cutting System

- ▲ Compatible rails with the manual cutting system. **Two systems, One rail**
- ▲ CE approved electric cutting machine, 1,500W, 230V/50Hz, 13,000RPM
- ▲ Suitable for cutting tiles size upto 3.2M
- ▲ Featured with 90degree and 45degree cutting
- ▲ Dry cutting with dust extractor hood and adaptor to the vacuum machine
- ▲ Max. Cutting depth 14mm
- ▲ Packed in plastic case and storage tool bag

Including:

- 2 x Premium cutting blade 125mm
- 3 x Aluminium fixing suction cup
- 2 x F clamp for fixing the rail
- 1 x Rubber adaptor

Art.No	Description
LFECMR	3.2M - 14mm
LFEC	Cutting Head
LFRS	Rail System

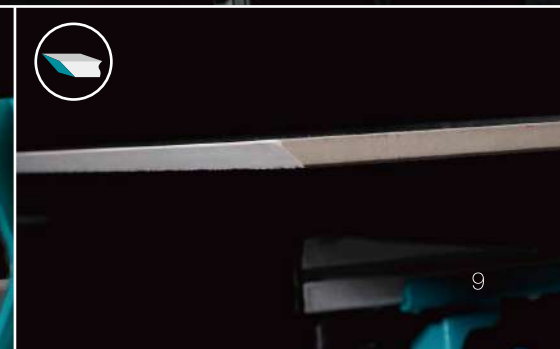



Transport Cart

- ▲ The ideal solution to move large format slabs of porcelain stoneware in the warehouse, places of installation offering a work area to apply the adhesive
- ▲ Thanks to the four rubber castors (lockable) positioned on each corner, superb control of movement and direction is created plus they make it extremely stable
- ▲ Max. Load: **280kg(617 lbs)**
- ▲ Suitable to display tile size upto 3.2 x 1.6M

Art.No	Size
LFCART	3.2x1.6M



Tilers Multi-function Workbench

- ▲ Reinforced portable workbench with ergonomic working height.
- ▲ Extendable tile supports for increased work surface upto 720mm.
- ▲ Longitudinal groove for 45°& 90°cutting and 110mm holes with drill guide for drilling
- ▲ Easy to put the manual tile cutter on it and can be used as a small scaffold
- ▲ Designed with four folding legs, carrying handles and wheels for easy transport
- ▲ Comes complete with two F clamps, adjustable rulers and restraints
- ▲ Table size 1160mm and straight cutting size 950mm

Art.No	Size
TWT900	116cm

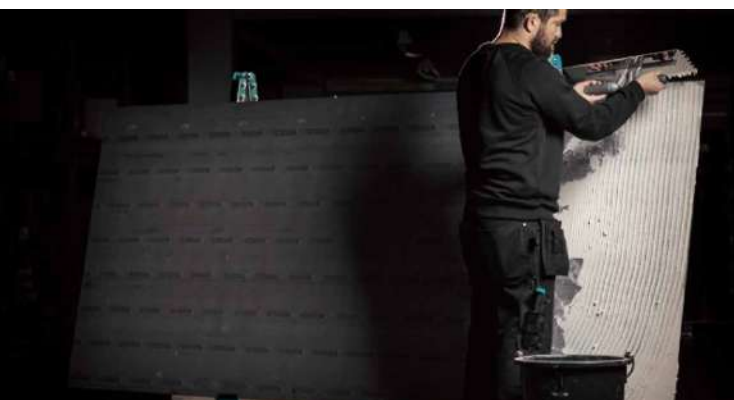

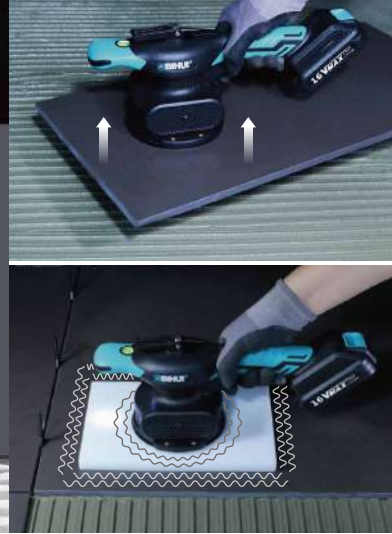

SELECT Vibration Tile Beater

- ▲ Powered with 21V lithium-ion battery
- ▲ Eco grip handle for maximum comfort
- ▲ Suction cup with 35kg lifting capacity
- ▲ Designed with digital control panel with 6 speeds
- ▲ Evenly distribute the adhesive under tiles and big slabs during installation

Art.No	Description	Data
LFTBA-Plus	Include 2 batteries	21V - 2Ah
LFTBA	Include 1 battery	21V - 2Ah
LFTBA-BAT	Battery	21V - 2Ah



Square Beating Block

- ▲ With 130x7mm opening in the middle
- ▲ Suitable for most suction cups
- ▲ For largely spread the vibration to the tiles
- ▲ Overall size 260x180x12mm

Art.No	Description	Data
LFTBV-BB	Tile Beating Block	Hole 130x7mm



CVT Vibration Tile Beater

- ▲ Continuously variable transmission speed
- ▲ Powered with lithium-ion battery
- ▲ TPR grip handle for maximum comfort
- ▲ Suction cup with 35kg lifting capacity
- ▲ Designed with spirit level bubble and working light
- ▲ Evenly distribute the adhesive under tiles and big slabs during installation
- ▲ Spare batteries available

Art.No	Description	Data
LFTBU	Include 2 batteries	16V - 2Ah
LFTBV	Include 1 battery	16V - 2Ah
LFTBV-BAT	Battery	16V - 2Ah



Tile Space & Level Regulator

- ▲ Ideal for adjust tile gap in horizon from 0.5mm to 40mm
- ▲ Two buttons for adjusting tile level
- ▲ With 2pcs 6 inch vacuum suction cup
- ▲ Light duty and durable structure
- ▲ Ideal for large porcelain or stone tiles and glass

Art.No	Size
LFTSB6	0.5-40mm



PREMIUM Tile Space & Level Regulator

- ▲ Designed to shortening gaps between tiles
- ▲ Adjustable from 0.5-40mm
- ▲ Two buttons for adjusting tile level
- ▲ Ideal for handling with porcelain or stone tiles and glass
- ▲ With 2pcs 6 inch vacuum suction pad

Art.No	Size
LFTSR2	0.5-40mm





Interchangeable Tile Space Regulator

- ▲ Ideal for adjust tile gap in horizon from 0,5mm to 40mm
- ▲ Two buttons for adjusting tile level
- ▲ With 2pcs removable vacuum suction cup, can be used alone
- ▲ Single 6"/8" vacuum suction cup can max. lifting 100/120Kg
- ▲ Ideal for large porcelain or stone tiles and glass

Art.No	Size
LFTSA6	6" x 2
LFTSA8	8" x 2



Multi Angle Tile Fixer & Adjuster

- ▲ With vacuum suction cup
- ▲ Work for 90°& 180°& 270°alignment and tile gap adjustment
- ▲ Two buttons for adjusting tile level
- ▲ Light duty and durable structure
- ▲ Ideal for handling with porcelain or stone tiles and glass

Art.No	Size
LFTFV6	Universal



Electric Cordless Vacuum Suction Cup

- ▲ The portable, electric battery vacuum suction lifter holds securely and firmly on almost any surface
- ▲ Extremely high suction power (up to max. 170 kg)
- ▲ Perfect for large formats, natural stone, thick terrace slabs, etc.
- ▲ Securely hold even on heavily structured, porous and damp surfaces
- ▲ Continuous working for 1.5hours
- ▲ Charging time for 2 hours

Includes:

- 1 x Spare rechargeable lithium-ion battery
- 1 x Extra foam rubber seal
- 1 x Interchangeable battery charger(USA,AU,EU)
- 2 x Filter felt
- 1 x User's manual
- 1 x Tool bag

Art.No	Description	Data
LFEVC	V1 with 2 batteries and 2 sealing ring	14.8V - 2.6Ah
LFEVC-H	H with assembled 1 battery and 1 ring	12V - 2Ah

Electric Vacuum Sucker

- ▲ Designed for the professionals, the vacuum-assisted lifting technology transforms the traditional method of heavy lifting
- ▲ Light weight and high vacuum capacity
- ▲ Wide range of application: Lifting for glass, marble, stone material, wood, metal material, etc.
- ▲ Lifetime is at least 3000 hours (Not including quick-wear part)
- ▲ Continuous working for 8.5 hours
- ▲ Voltage: 14,8V
- ▲ Charging Time: 1 Hour
- ▲ Max. Lift: 70kg
- ▲ Set Includes 2 Batteries

Art.No	Description	Data
LFEVS	With 2 batteries and 2 sealing ring	14.8V - 2Ah





8" Vacuum Suction Cup

- ▲ Lifting capacity 110Kg (243lbs)
- ▲ Anti-slip plastic handle
- ▲ Pump action & quick release lever
- ▲ Suitable for both smooth and texture surface

Art.No	Size	
SCVU8	200mm	8"



6" Vacuum Suction Cup

- ▲ Lifting capacity 100Kg (220lbs)
- ▲ Heavy duty steel handle & brass tube
- ▲ Pump action & quick release lever

Art.No	Size	
SCVM6	150mm	6"



6" Vacuum Suction Cup With Pressure Monitor

- ▲ Lifting capacity 100Kg (220lbs)
- ▲ Heavy duty steel handle & brass tube
- ▲ Pump action & quick release lever

Art.No	Size	
SCVM6	150mm	6"



8" Vacuum Suction Cup

- ▲ Lifting capacity 120Kg (265lbs)
- ▲ Durable multi-level rubber
- ▲ Heavy duty steel handle & brass tube
- ▲ Pump action & quick release lever
- ▲ Ideal for large porcelain or stone, tiles and glass

Art.No	Size	
SCVM8	200mm	8"



8" Vacuum Suction Cup With Pressure Monitor

- ▲ Lifting capacity 120Kg (265lbs)
- ▲ Durable multi-level rubber
- ▲ Heavy duty steel handle & brass tube
- ▲ Pump action & quick release lever
- ▲ Ideal for large porcelain or stone, tiles and glass

Art.No	Size	
SCVG8	200mm	8"



8" Vacuum Suction Cup With Pressure Monitor

- ▲ Lifting capacity 120Kg (265lbs)
- ▲ Anti-slip soft grip handle
- ▲ Durable structure and light weight
- ▲ Quick release lever & comfort pump action
- ▲ Suitable for both smooth and texture surface
- ▲ Ideal for large porcelain or stone, tiles and glass

Art.No	Size	
SCVB8	200mm	8"



Mega Suction Cup

- ▲ Lifting capacity: 40kg (88lbs)
- ▲ Made of aluminium with rubber suction cup
- ▲ Jumbo ergonomic comfort handle
- ▲ Ideal of carrying ceramic tiles, marble and glass

Art.No	Size	
SCSB4	122mm	4.8"



Mega Double Suction Cup

- ▲ Lifting capacity: 85kg (187lbs)
- ▲ Made of aluminium with rubber suction cup
- ▲ Jumbo ergonomic handle and comfort fixing buttons
- ▲ Ideal of carrying ceramic tiles, marble and glass

Art.No	Size	
SCDB4	125mm	5"



Mega Triple Suction Cup

- ▲ Lifting capacity: 110kg (243lbs)
- ▲ Made of aluminium with rubber suction cup
- ▲ Jumbo ergonomic handle and comfort fixing buttons
- ▲ Ideal of carrying ceramic tiles, marble and glass

Art.No	Size	
SCTB4	125mm	5"



Tile Beater

- ▲ Eliminate air from underneath the tile
- ▲ Heavy duty rubber pad

Art.No	Size	
BLFTBT	355 x 146 x 10mm	



Tile Protector

- ▲ 4pcs per pack
- ▲ Can be used multiple times
- ▲ Avoiding potential damage to the tiles

Art.No	Size	
LFTP06	6mm	1/4"
LFTP08	8mm	5/16"
LFTP10	10mm	3/8"





15pcs

Professional Jumbo Notched Trowel Set

- ▲ 2pcs x interchangeable soft grip handle
- ▲ Switch between trowel blades to be used both right and left handed
- ▲ 6pcs x Stainless steel blades in 280x115mm
- ▲ Notched 6,8,10,12mm, Tiger notch and 10x20mm Round Notch
- ▲ 6pcs x Stainless steel blades in 480x130mm
- ▲ Notched 6,8,10,12mm, Tiger notch and Diagonal notch
- ▲ Storage and drain box for 280x115mm blades
- ▲ Professional trowel set and saves storage space

Art.No	Size	Notch Guide
PTSJK15	280x115mm (11"x4-1/2")	6mm SQ notch
		8mm SQ notch
		10mm SQ notch
		12mm SQ notch
		10x20mm Round Notch
		Tiger notch
	480x130mm (19"x5-1/8")	6mm SQ notch
		8mm SQ notch
		10mm SQ notch
		12mm SQ notch
		Diagonal notch
		Tiger notch

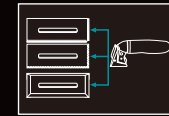
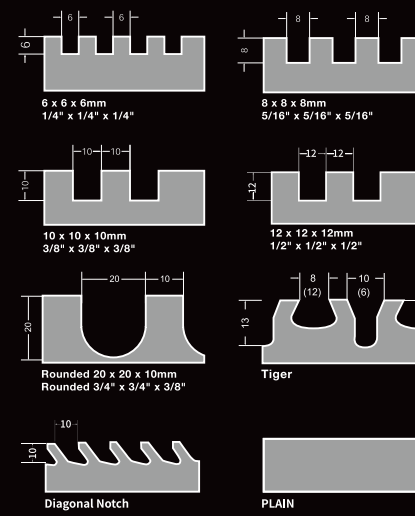

Easy-Attach
Switch between floats and trowels with the convenience of only one handle

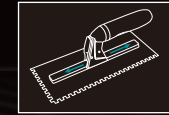

Slide-Lock Handle
For secure and adjustable placement along trowels and floats.

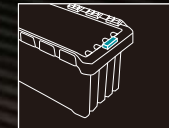

Blade Lock
Stores trowel and floats securely.



Drain System
Leaves your blades and floats dry while in storage.



Notched Trowel Set

- ▲ Stainless Steel Blades 280x115mm
- ▲ Interchangeable TPR Handle
- ▲ Square notch 6, 8, 10 & 12mm
- ▲ Round Notch 20x20x10mm
- ▲ Universal Tiger Trowel
- ▲ Storage drain box

Art.No	Size	Notch Guide
PTSJG8	280x115mm (11"x4-1/2")	6mm SQ notch
		8mm SQ notch
		10mm SQ notch
		12mm SQ notch
		10x20mm Round Notch
		Tiger notch



Interchangeable Blade

- ▲ #420 Stainless Steel
- ▲ Different notches available
- ▲ Size: 280x115mm(11"x4-1/2")



Interchangeable Blade

- ▲ #420 Stainless Steel
- ▲ Different notches available
- ▲ Size: 480x130mm(19"x4-1/2")



Interchangeable Handle

- ▲ Quick lock & release clamp

Notched Trowel

- ▲ Contoured handle for improved comfort and control
- ▲ Handle support held to blade with 13 mounted rivets
- ▲ 0.7mm quality stainless steel blade
- ▲ Range of notch size to suit any job



Art.No	Size	Notch Guide
PTSL06	320x120mm (12-1/2"x4-3/4")	6mm SQ notch
PTSL08		8mm SQ notch
PTSL10		10mm SQ notch
PTSL12		12mm SQ notch
PTSLTG		Tiger notch

Notched Trowel

- ▲ Contoured handle improves control and comfort
- ▲ Handle fastened to blade with 8 mounted rivets
- ▲ 0.7mm quality stainless steel blade
- ▲ Range of notch size to suit any job



Art.No	Size	Notch Guide
PTSB04	280x120mm (11"x4-3/4")	4mm SQ notch
PTSB06		6mm SQ notch
PTSB08		8mm SQ notch
PTSB10		10mm SQ notch
PTSB12		12mm SQ notch
PTSB20		Round Notch
PTSBTG	Tiger notch	
PTSBPL	Plain	

Notched Trowel

- ▲ Contoured handle improves control and comfort
- ▲ Handle fastened to blade with 6 welded rivets
- ▲ 0.6mm quality spring steel base
- ▲ Range of notch size to suit any job
- ▲ Size: 280x115mm / 11"x4-1/2"

Art.No	Size	Notch Guide
PTCB06	280x115mm (11"x4-1/2")	6mm SQ notch
PTCB08		8mm SQ notch
PTCB10		10mm SQ notch
PTCB12		12mm SQ notch
PTCBTG		Tiger notch



Bucket Trowel

- ▲ High strength carbon steel
- ▲ Soft grip handle

Art.No	Size
BTCHB6	160mm 6-3/8"



Gauging Trowel

- ▲ High strength carbon steel
- ▲ Soft grip handle

Art.No	Size
BTCHG8	200mm 8"



Margin Trowel

- ▲ High strength carbon steel
- ▲ Soft grip handle

Art.No	Size
BTCHM5	125mm 5"

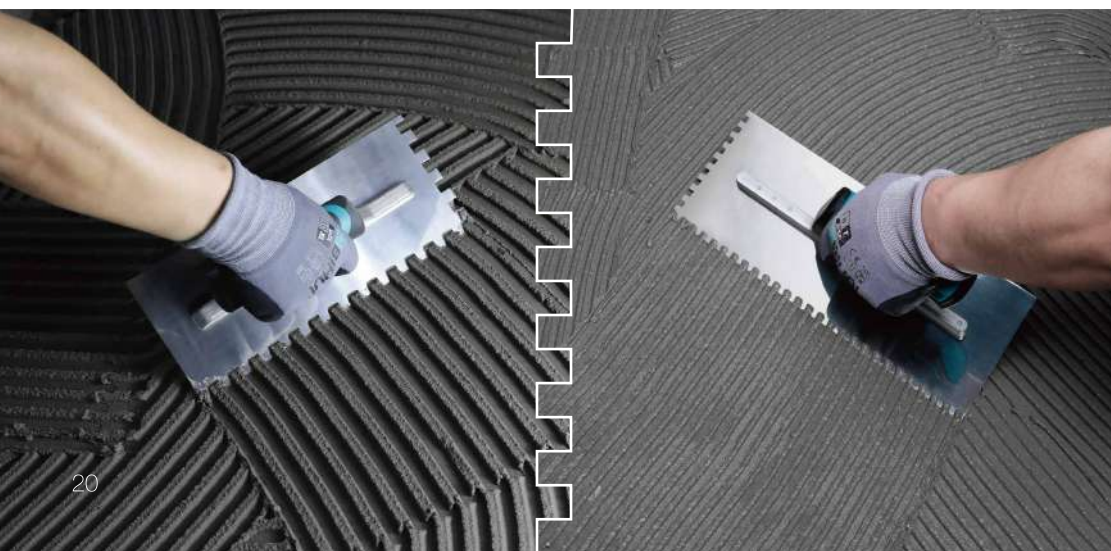

Professional Taping Knife

- ▲ Stainless steel blade with mirror-polished for easy cleanup
- ▲ Lightweight, ergonomically designed handle for all-day use

Art.No	Size
PTK22	220mm 8-5/8"
PTK20	300mm 12"
PTK50	500mm 20"
PTK60	600mm 24"



Bucket Scoop

- ▲ Curved blade design for clean removal of materials
- ▲ Stainless steel blade with soft grip handle
- ▲ Designed to fit most mixing and grouting buckets

Art.No	Size
PTK165	165mm 6-1/2"



Smart 19L
Trade washy bucket



19L Tile Washing Set

- ▲ Durable bucket with wheels and stands
- ▲ Arc-shaped pouring edge and ergonomic handle
- ▲ Triple rollers for fast water extraction
- ▲ Heavy duty plastic grid, stay still in place
- ▲ Soft grip sponge float with block cut
- ▲ Soft grip EVA float with high density
- ▲ Ideal for cleaning floor and wall tiles & applying grouts

Art.No	Description
TWS19	6pcs kit
TWS19A	4pcs kit
TWS19G	Grid
TWS19R	Roller



Durable Plastic grid



Tri-roller, triple efficiency



Arc-Shaped Edge



Rotary wheels and anti-slip stands



Sponge Float

- ▲ Hydro sponge with block cut

Art.No	Size
CFHSP11	280x140x30mm (11"x5-1/2"x1-3/16")



Professional Sponge Float

- ▲ Soft grip handle
- ▲ Hydro sponge with block cut

Art.No	Size
CFHSS11	280x140x30mm (11"x5-1/2"x1-3/16")



Hydro Grouting Sponge

- ▲ Ideal for cleaning tiles after grouting

Art.No	Size
CFHS165	165x110x60mm (6-1/2"x4-3/8"x2-3/8")



EVA Grout Float

- ▲ With plastic handle

Art.No	Size
CFEP11	280x140x9mm (11"x5-1/2"x5/16")



EVA Grout Float

- ▲ Soft grip handle

Art.No	Size
CFES11	280x140x8mm (11"x5-1/2"x5/16")



Cellulose Sponge

- ▲ 100% Cellulose
- ▲ Ideal for all types of cleaning and decorating

Art.No	Size
CFCS165	165x110x50mm (6-1/2"x4-3/8"x2")



Epoxy Grout Float

- ▲ Green hard rubber

Art.No	Size
CFHRL	248x116mm (10"x4-1/2")



Grout Float

- ▲ Soft grip handle
- ▲ Aluminium base with high density EVA
- ▲ Rubber pad

Art.No	Size
CFERS	240x100mm (9-3/8"x4")



Cleaning Pads

- ▲ Excellent for the removal of grout or adhesive from tile surfaces
- ▲ Including 3 pads in super fine, medium and course

Art.No	Size
CSPK4	250x120mm (10"x4-3/4")



TILING TOOLS



Wall Tile Leveling Lifter

- ▲ Convenient adjustment allows for 1-25cm free height adjustment
- ▲ Quick release level for minor adjust and removal
- ▲ Single loading capacity is 80Kg
- ▲ Ideal for facilitating the laying of large tiles on the wall

Art.No	Size
TAS25	1-25mm



Rubber Mallet

- ▲ Soft grip

Art.No	Size
RMWO24	24OZ



Tiler's Gloves

- ▲ Provides excellent grip and movement when handling tile and stone
- ▲ Wear-resistant, stain-resistant Elastic ventilate, comfortable

Art.No	Size
TGDL	9 / L
TGDXL	10 / XL
TGDXXL	11 / XXL



One Piece Rubber Mallet

- ▲ Comfort grip

Art.No	Size
RMWS24	24OZ



Tile Remover Scraper

- ▲ Ideal for removing tiles and adhesives
- ▲ 100mm (1.2mm thick) steel blade
- ▲ Rubber pro grip handle
- ▲ Steel cap for extra strength

Art.No	Size
TRSC4	100mm 4"



Tile Markers

- ▲ Black, White and Red
- ▲ For marking on variety of surfaces for cutting and drilling jobs

Art.No	Size
TOM3	180mm 7"



Profile Gauge

- ▲ Quick and easy way to copy awkward shapes
- ▲ Utilizing individually tensioned
- ▲ Low friction plastic blades
- ▲ Ideal for tiling, wallpaper, laying carpet, laminate flooring

Art.No	Size
TPG250	250mm 10"



Profile Gauge with Lock

- ▲ Utilizing individually tensioned
- ▲ Low friction plastic blades
- ▲ With blade locking system
- ▲ Magnetic for hands-free working
- ▲ Metric and imperial scale

Art.No	Size
TPL250	250mm 10"



Grout and Sealant Repair Kit

- ▲ Finishing profiles with 3R(1/8R) and 6R(1/4R)
- ▲ Grouting nozzle for cartridge
- ▲ Silicone and sealant removing knives
- ▲ Quick and easy to use and clean

Art.No	Size
STARK3	Universal



Compound Tile Nipper

- ▲ Triple Power - same effort
- ▲ Comfort grip handle
- ▲ Maximum tile thickness 12mm
- ▲ Ideal for irregular cuts in ceramic and porcelain tile

Art.No	Size
TNC10	250mm 10"



Silicone Applicator Kit

- ▲ Has half round cut outs to create a quadrant seal
- ▲ Has straight cut edges to provide a triangular seal
- ▲ Easy to use tool, no need to tape or mask joints

Art.No	Size
STAK2	60x60mm (2-3/8")



Silicone Applicator Kit

- ▲ Finishing profiles in 0R,2R,3R,4R, 5R,6R,8R,10R,12R,14R,20R
- ▲ Easy to use, no need to tape or mask joints
- ▲ Designed to shape silicone sealant for a perfect neat finish

Art.No	Size
STAK4	46x46mm (1-3/4"x1-3/4")



Grout Rake

- ▲ With TPR soft grip handle
- ▲ Use to remove old grout between tiles
- ▲ Length 200mm
- ▲ 2 x tungsten carbide blades

Art.No	Size
TGRS2	200mm 8"



Grout Rake Blades

- ▲ 2 x tungsten carbide blades
- ▲ For use with BIHUI Grout Rake

Art.No	Size
TGRSB2	Spare blades for TGRS2



Straight Tile Nipper

- ▲ Designed to form narrow strips and shapes from wall or floor tiles
- ▲ Drop forged
- ▲ Carbide tipped-straight jaw
- ▲ Soft grip handle

Art.No	Size
TNS8	200mm 8"



Breaking Tile Nipper

- ▲ A dual purpose tool for cutting and breaking small wall tiles
- ▲ Carbide wheel, metal construction
- ▲ Comfort grip handle

Art.No	Size
TNB8	200mm 8"



Leather Knee Pads

- ▲ Soft and broad strap
- ▲ Single velcro front fastening strap
- ▲ Washable & durable
- ▲ Premium Grade Neoprene
- ▲ Heavy duty closed cell foam cushion

Art.No	Size
BLKP	Universal



Gel Knee Pads

- ▲ Foam core for maximum cushioning
- ▲ Gel cover for extra comfort
- ▲ Velcro straps & Pressure clip for added security
- ▲ Ergonomic design
- ▲ With great stability, preventing ligament and tendons fatigue

Art.No	Size
TKPG	Universal



TPR Knee Pads

- ▲ Waterproof and anti-slip engineered cover
- ▲ Made of breathable diving cloth and oxford fabric
- ▲ Durable reinforced stitching & extra foam core
- ▲ Soft gel core and thick cushioned foam core provides superior protection
- ▲ Easy & secure velcro fastening system
- ▲ Protects against nails, screws, glass and debris

Art.No	Size
TKPT	Universal



PVC Knee Pads

- ▲ PE and silicone insert for maximum cushioning
- ▲ PVC cover
- ▲ Velcro straps
- ▲ Made of diving cloth and oxford fabric

Art.No	Size
TKPP	Universal



Reusable Tile Leveling System

- ▲ Holds tile level & eliminates lippage
- ▲ Ideal for walls and floors tiles up to 17mm
- ▲ Suitable for tile clearance 1,5-6 mm
- ▲ Used in conjunction with other levelling systems or spacers
- ▲ Anti-scratching large cap and fast spin-down handle
- ▲ Reusable and all in one, saves both time and money



Art.No	Size		Qty
TSL50	1.5mm	1/16"	50pcs

The world's first all-in-one reusable tile leveling system

HOW TO USE

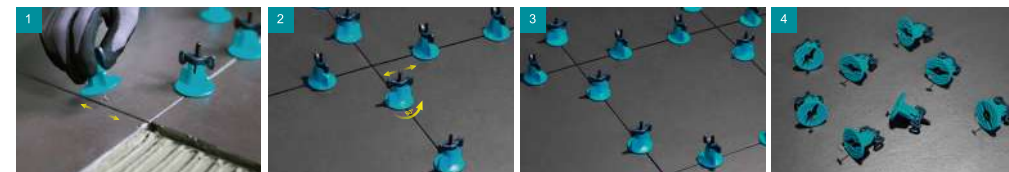

1. Insert T-pin parallel into the grout joint (For a wider joint, use classic spacers together)
 2. Hold the blue cap in 90° position and spin down the gray handle
 3. Twist the gray handle down to the required level (no tools needed)
 4. Return parallel back for 90° to the grout joint for reuse (Note: remove within 24 hrs)*

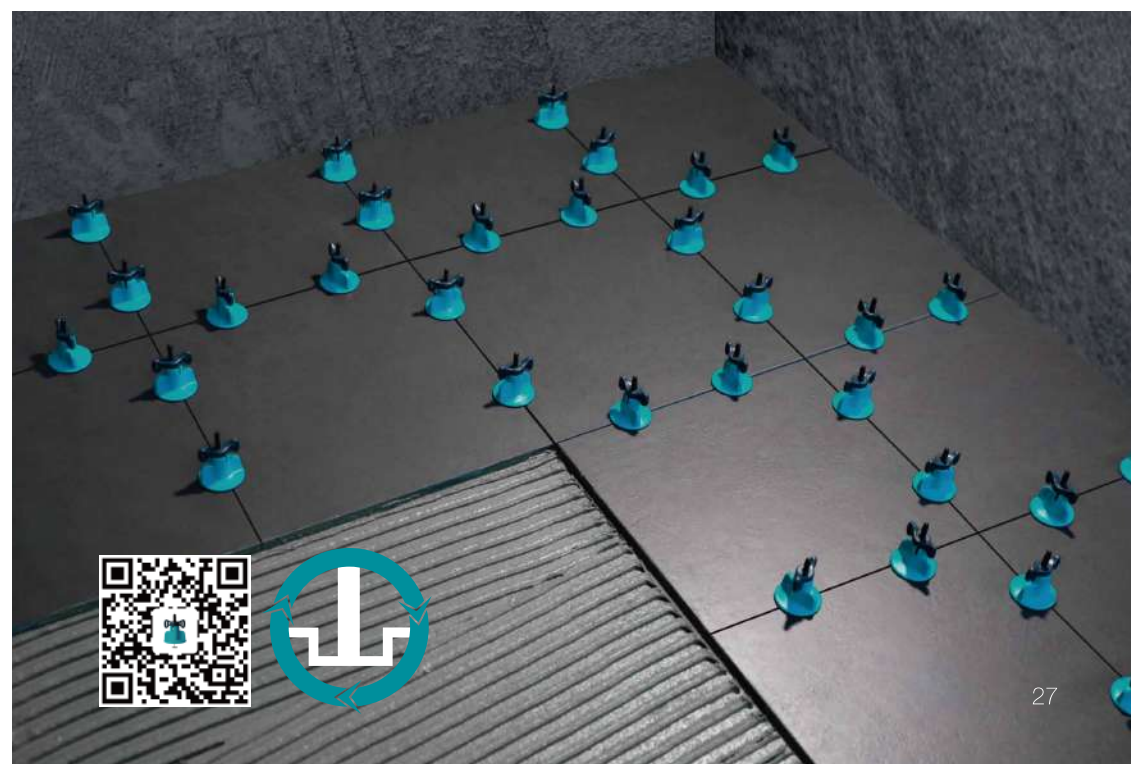

LEVELLING SYSTEM



Tile Levelling Spacer

- ▲ Holds tiles level
- ▲ Ideal for walls & floors
- ▲ Eliminates lippage on uneven tiles

Art.No	Size	Qty
BLS1100	1mm(3/64")	100pcs
BLS1250	1mm(3/64")	250pcs



Tile Levelling Spacer

- ▲ Holds tiles level
- ▲ Ideal for walls & floors
- ▲ Eliminates lippage on uneven tiles

Art.No	Size	Qty
BLS2100	2mm(1/16")	100pcs
BLS2250	2mm(1/16")	250pcs



Tile Levelling Spacer

- ▲ Holds tiles level
- ▲ Ideal for walls & floors
- ▲ Eliminates lippage on uneven tiles

Art.No	Size	Qty
BLS3100	3mm(1/8")	100pcs
BLS3250	3mm(1/8")	250pcs

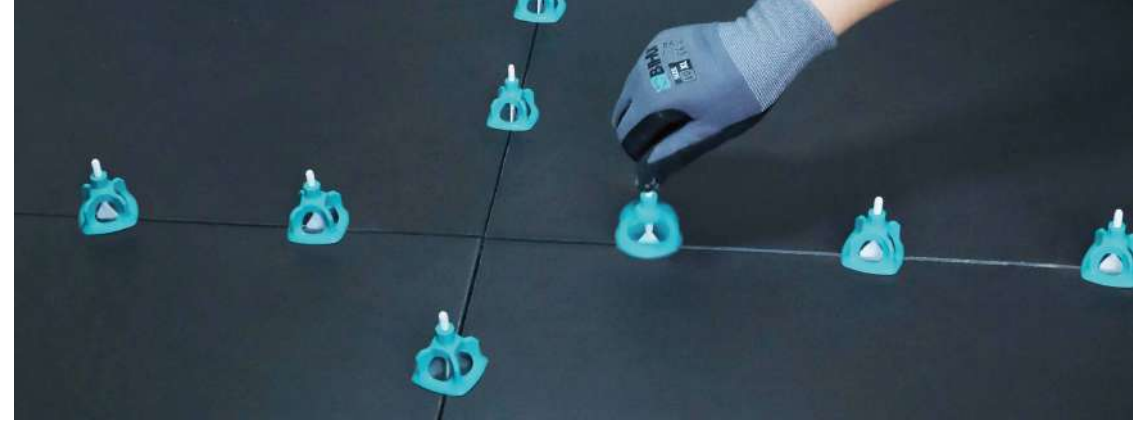

Tile Levelling Wedges

- ▲ Holds tiles level
- ▲ Ideal for walls & floors
- ▲ Eliminates lippage on uneven tiles
- ▲ With spacer function for 1,2,3mm
- ▲ Used for 2-15mm tile

Art.No	Size
BLSE100	90x22x17mm (3-1/2"x2"x5/8"x5/8")



Tile Levelling Plier

- ▲ Improved accuracy and installation speed
- ▲ Fast adjustable space mechanic
- ▲ Ergonomic comfort handle
- ▲ Maximum working depth 12mm
- ▲ Ideal for Walls and Floors

Art.No	Size
BLSFP	Universal



Tool Bag 20"

- ▲ 16pcs individual pockets
- ▲ Made of 600D polyester cloth
- ▲ With carry handle and shoulder strap

Art.No	Size
TBD20	51x26x30cm (20"x1-3/64"x1-3/16")

HOW TO USE

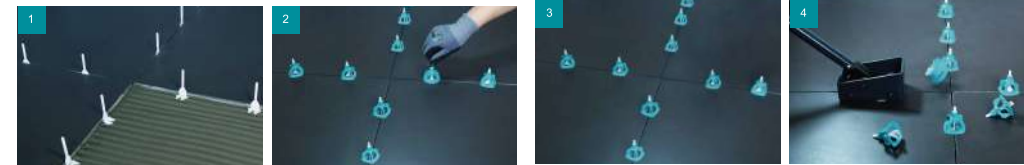

- Place the level base under the tiles 10 cm from either end
- Apply the level washer and level cap to the level base
- Spin down the level cap to the required level to ensure no lippage
- Remove the cap with BIHUI levelling dozer for reuse



Spin Level Base 1mm

- ▲ Holds tiles level
- ▲ Ideal for walls & floors
- ▲ Eliminates lippage on uneven tiles

Art.No	Size	Qty
SL1100	1mm(3/64")	100pcs



Spin Level Base 2mm

- ▲ Holds tiles level
- ▲ Ideal for walls & floors
- ▲ Eliminates lippage on uneven tiles

Art.No	Size	Qty
SL2100	2mm(1/16")	100pcs



Spin Level Base 3mm

- ▲ Holds tiles level
- ▲ Ideal for walls & floors
- ▲ Eliminates lippage on uneven tiles

Art.No	Size	Qty
SL3100	3mm(1/8")	100pcs

BASE LEVEL

COVERAGE

A cm	10	15	20	25	30	33	40	45	50	60	80	100
10	200											
15	133	89										
20	100	67	50									
25	80	53	40	32								
30	100	67	50	40	44							
33	91	61	45	36	40	37						
40	75	50	37	30	33	30	25					
45	67	44	33	27	30	27	22	20				
50	60	40	30	24	27	24	20	18	16			
60	50	33	25	20	22	20	15	13	11			
80	30	23	20	21	19	17	14	12	10	9		
100	44	30	22	18	17	16	12	11	9	8	7	
150	50	33	25	20	20	18	14	13	12	10	9	8
200	42	28	21	17	17	15	13	11	10	8	7	6

Example: A = 60cm, B = 30cm
22 pcs / m² required

HOW TO USE

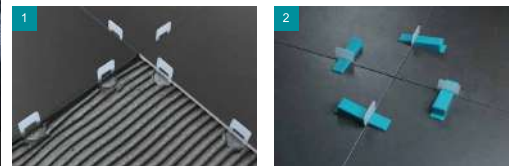

- Place the level base under the tiles 10 cm from either end
- Insert the reusable wedge into each level base

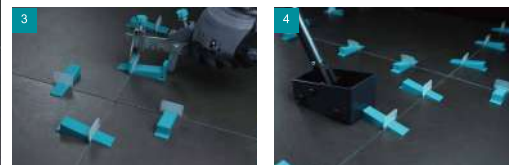

- Use the plier to tighten to the required level
- Remove the wedge with BIHUI levelling dozer for reuse



Spin Level Cap

- ▲ Holds tiles level
- ▲ Ideal for walls & floors
- ▲ Eliminates lippage on uneven tiles

Art.No	Size	Qty
SLC100	Universal	100pcs



LEVELLING SYSTEM

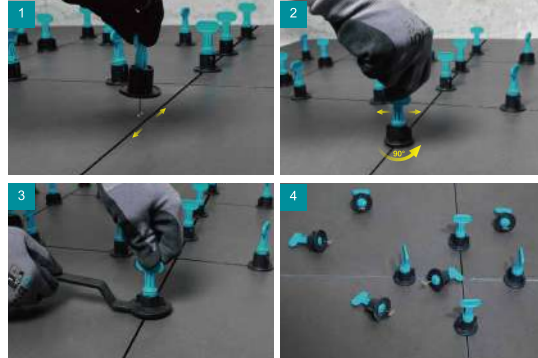

Reusable Tile Leveling System

- ▲ Holds tiles level & eliminates lippage
- ▲ Ideal for walls and floors
- ▲ Suitable for tile clearance 1.5-6mm
- ▲ For a wider joint, use classic spacers
- ▲ Used in conjunction with other leveling systems
- ▲ Suitable for 2-17mm tiles

Art.No	Size	Qty
TSS100	1.5mm(1/16")	100pcs



3 tubes to be connect together

Levelling System Removal Roller

- ▲ High quality and smooth nylon wheels
- ▲ Chamfer design to prevent tiles from scratching
- ▲ Ergonomic handle and 1.35M length for standing working
- ▲ Triple efficient for removing all types of tile leveling system

Art.No	Size
BLSRR	1.4M 55"

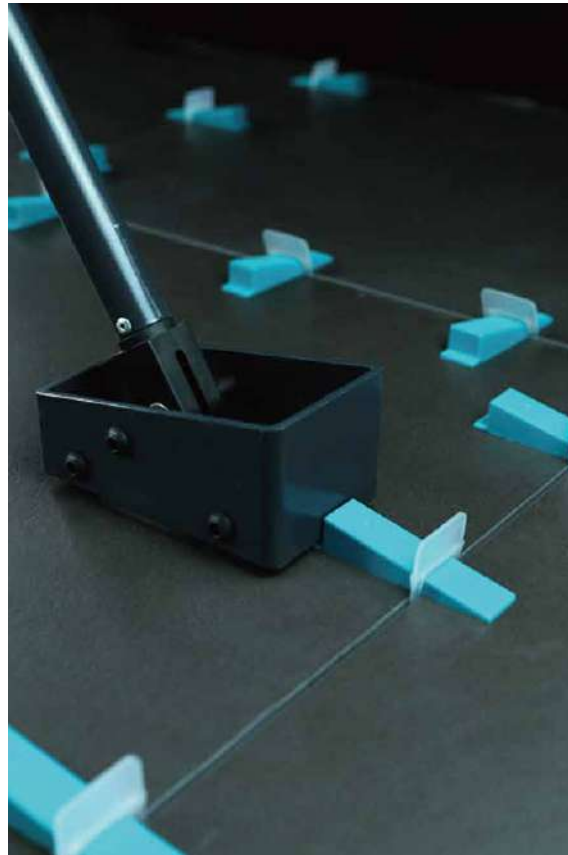

TILE SPACERS



Horseshoe Shim

- ▲ High impact reusable plastic shim
- ▲ For both horizontal and vertical tile installation
- ▲ Easy to install & Easy to remove
- ▲ For aligning marble, granite, porcelain and large format tile

Art.No	Size	Qty
HSB400	1.5mm 1/16"	400pcs
HSP350	2mm 3/32"	350pcs
HSR300	3mm 1/8"	300pcs
HSY220	5mm 3/16"	220pcs
HSB150	6mm 1/4"	150pcs

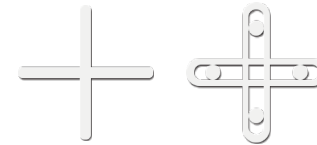

Tile Spacers

- ▲ 250 pieces per reseal bag
- ▲ Ideal for wall and floor tiles

Art.No	Size	Qty
TSC1250	1.5mm 1/16"	250pcs
TSC2250	2mm 3/32"	250pcs
TSC3250	3mm 1/8"	250pcs
TSC5250	5mm 3/16"	250pcs



Tile Spacers

- ▲ 250 pieces per reseal bag
- ▲ Ideal for wall and floor tiles

Art.No	Size	Qty
TST2250	2mm 3/32"	250pcs
TST3250	3mm 1/8"	250pcs
TST4250	4mm 5/32"	250pcs
TST5250	5mm 3/16"	250pcs



Multi Size Spacer

- ▲ 50pcs per reseal bag
- ▲ Reusable
- ▲ Ideal for wall and floor tiles

Art.No	Size	Qty
TSM50	4 in 1	50pcs



Rotate Wedge

- ▲ 50pcs per reseal bag
- ▲ Reusable
- ▲ Ideal for wall and floor tiles

Art.No	Size	Qty
TSR50	1-13mm	50pcs



Tile Wedge

- ▲ 250pcs per reseal bag
- ▲ Ideal for wall and floor tiles

Art.No	Size	Qty
TSW250	0.5-5mm	250pcs

INCISE Tile Cutter

- ▲ One-piece aluminum alloy die casting forming base
- ▲ Single rail system, simple and durable
- ▲ Integral molding design for breaking part, cutting head and handle
- ▲ Smart and easy adjusting knob for fitting with different thickness tiles
- ▲ Suitable for cutting with 90° or any angles.
- ▲ Visible cutting angle and scale plate in white and black
- ▲ Readable ruler with double row scale and pointing arrow
- ▲ Angle positioning with limitation design for easy and precise location
- ▲ Storable inclined bracing for extra support

NEW

Art.No	Cutting Length		Diagonal Cutting Length(cm)	Cutting Thickness (mm)	Breaking force (kg)
TCA630	630	25"	44 x 44	5 - 20	1000
TCA750	750	29-1/2"	53 x 53	5 - 20	1000
TCA930	930	36-1/2"	66 x 66	5 - 20	1000
TCA1250	1250	49"	88 x 88	5 - 20	1000



C-Lion Tile Cutter

- ▲ Double-layer aluminum alloy chassis, strong and durable
- ▲ Tungsten carbide scoring wheel with etched scale for using with different tile thickness
- ▲ Anti-rotation handle for change scoring wheels from Ø1/4" (6mm) to Ø7/8"(22mm)
- ▲ Ø7/8"(22mm) scoring wheel included
- ▲ Magnetic absorption and fast release breaking device with 800kg breaking power for single-handed operation
- ▲ Adjustable measurement guide and side ruler for cutting tiles from different angle
- ▲ Anti-slip handle with storage function and snap-in for locking the handle
- ▲ LED light for extra vision
- ▲ 1M and 1.2M tile cutter with caster design
- ▲ Suitable for cutting all kinds of ceramic tiles, such as wall tiles, polished tiles and glazed tiles

Art.No	Cutting Length		Diagonal Cutting Length(cm)	Cutting Thickness (mm)	Breaking force (kg)
TCB800	800	31-1/2"	56 x 56	3 - 18	800
TCB1000	1000	40"	70 x 70	3 - 18	800
TCB1200	1200	47-1/4"	85 x 85	3 - 18	800

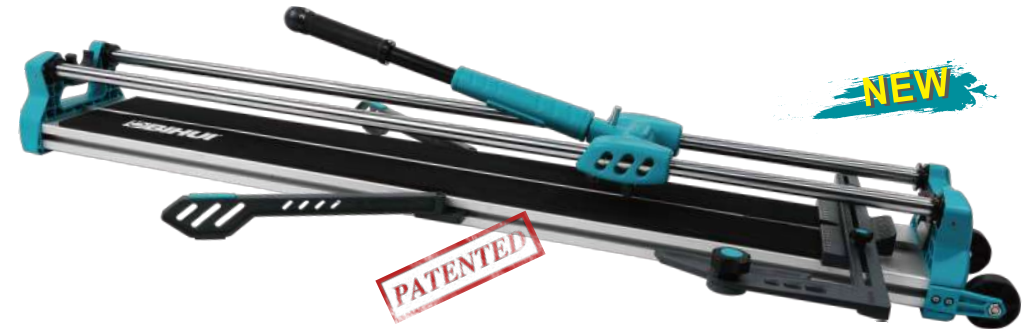

1.Cutting Wheel 2.LED working light



3.Elastic support plate 4.Inclined bracing



5.Angle positioning 6.Thickness adjuster



1.Magnetic absorption breaking device 2.Quick change a wheel



3.Snap-in for locking the handle 4.Adjustable measurement guide and side ruler



5.LED light 6.Anti-slip handle with storage function



Professional Tile Cutter

- ▲ Aluminium die casting one-piece base, strong and durable
- ▲ Single guide rail with built-in ball bearing system, easy for cutting big tiles
- ▲ Ergonomic soft grip handle, labour-saving
- ▲ Extension bars to support large tiles
- ▲ Magnetic absorption breaking device, single-handed operation
- ▲ Gauge for straight and angled cutting, both in metric and inches
- ▲ Ø7/8"(22mm) scoring wheel included, quick replacement design

Art.No	Cutting Length	Diagonal Cutting Length(cm)	Cutting Thickness (mm)
TCC900	900	36"	635 x 635
TCC1200	1200	47-1/4"	850 x 850
TCC1650	1650	65"	1170 x 1170

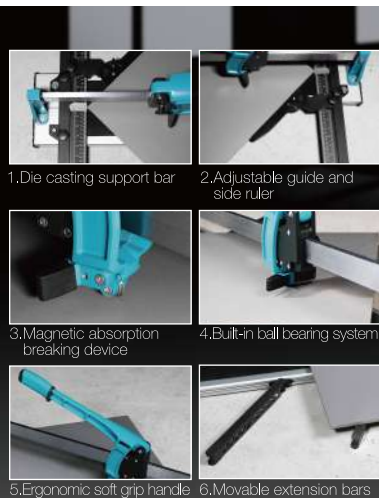

1.Die casting support bar 2.Adjustable guide and side ruler
3.Magnetic absorption breaking device 4.Built-in ball bearing system
5.Ergonomic soft grip handle 6.Movable extension bars



5 Lines Laser Level

- ▲ Auxiliary tiles fixing, wall decoration, floor tiles fixing, stair handrails, furred ceiling, floor tile, plastering etc

Art.No	Description	Data
LLG05	Euro Charger	3.7V - 5.2Ah

Accessories includes:

- USB charging
- Lithium-ion Battery
- Laser target plate
- Green glasses
- Bracket with adjusting and level spirit



12 Lines Laser Level

- ▲ Auxiliary tiles fixing, wall decoration, floor tiles fixing, stair handrails, furred ceiling, floor tile, plastering etc

Art.No	Description	Data
LLG12	Euro Charger	3.7V - 5.2Ah
LLG12A	U.S Charger	3.7V - 5.2Ah

Accessories includes:

- USB charging
- Lithium-ion Battery
- Laser target plate
- Green glasses
- Bracket with adjusting and level spirit
- Magnetic bracket PV9 & PV6+





Leveling Compound Mixing Station

- ▲ Mixes up to 100kg with hands free
- ▲ Ergonomic handle and damping structure angles for pouring
- ▲ Removable 1900W mixing machine and large paddle
- ▲ Brake transporting castors and light weight frame
- ▲ Arc-shaped pouring spout and dust cover plate
- ▲ Suitable for mixing self-levelling cement, compounds & epoxies with good fluidity

Technical Data	
Art.No	MS1900
Measurement	745x560x997mm
Net Weight	33,5Kg
Power	1900W
Voltage/Frequency	230V/50-60HZ
No load speed	1st 150-300rpm/min
Mixing Paddle	2nd 300-650rpm/min 300x600mm
Capacity	100L
Noise measurements	LpA=85,8dB(A)
LpA [dB(A)]	LpA =85,8dB(A)
LpCpeak (dB)	Less than 130dB(A)
KpCpeak (dB)	
Lwa [dB(A)]	LwA =96,8dB(A)
KwA [dB(A)]	Kwa=3 dB(A)
Work mode - vibration emission value a (m/s ²)	ah,D=1,695m/s ²
Uncertainty K (m/s ³)	K= 1,5 m/s ²

Manufacturer reserves the right to change specifications without notice.
Specifications may differ from country to country



Technical Data	
Art.No	MME1200
Output	1200W
Voltage	230V/50Hz
Speed	150-300rpm/min 300-650rpm/min
Fitting	M14
Paddle	120 x 600mm

Mixer 1200W

- ▲ Heavy duty gear system with large torque
- ▲ With 300 hours continued working time
- ▲ Paddle swing < 0,5mm without fatigue
- ▲ Maximum mixture loading 40L
- ▲ Suitable for mixing cement, paints, tile adhesive, glue etc



Soft start and constant speed

Six speed for choosing

Quick installing mixing paddle



Portable Mortar Mixer

- ▲ Powerful mixer with a compact and robust design
- ▲ Removable paddles for easy cleaning
- ▲ Drum capacity 120L, 100L mixing capacity
- ▲ Socket opener on the lid for easier filling
- ▲ Suitable for mixing a variety of substances including cement, mortar, plaster and concrete

Technical Data	
Art.No	MM1500
Power	1500W
Voltage	230V
Frequency	50HZ
Motor Power	1600RPM
Drum Capacity	120L
Drum Mouth Diameter	690mm
Drum Rotate Speed	30RPM
Loading	120kgs
Overall Dimensions	760 x 820 x 1170mm
Net Weight	127kgs

Manufacturer reserves the right to change specifications without notice.
Specifications may differ from country to country





Twist Mixing Paddle

- ▲ M14 steel handle with metal hanger
- ▲ Golden zinc plated
- ▲ Suitable for mortar, tile adhesive, plaster, screed and filling compounds

Art.No	Size
MPGZ600	140xM14 x600mm



Spiral Mixing Paddle

- ▲ M14 steel handle with metal hanger
- ▲ Golden chrome plated
- ▲ Suitable for mortar, tile adhesive, plaster, screed and filling compounds

Art.No	Size
MPSC600	140x M14x600mm



Paint Mixing Paddle

- ▲ Hexagon shaft to fit drill machine
- ▲ Powder coating
- ▲ Suitable for mixing mud and paint

Art.No	Size
MPPS400	80x8x400mm



Bucket Dust Collector

- ▲ Ideal for dust extraction in the filling and mixing process
- ▲ Quick clamping on the bucket with spring
- ▲ 3-steps rubber connector to the vacuum cleaner
- ▲ Fast extraction design for reduced dust
- ▲ Suitable for mixing bucket upto 35mm thickness
- ▲ Benefits to health and environment

Art.No	Size
TDBM	Universal



Vacuum Cleaner 30L

- ▲ Suitable for extracting solid particles (dust and cutting waste) and water
- ▲ Semi-automatic HEPA filter cleaning system
- ▲ Blower function
- ▲ Dust full indicator
- ▲ Power tool socket function
- ▲ On-board accessory storage
- ▲ Drain device for convenient liquid disposal
- ▲ Convenient hose hook for easy transport and storage

Technical Data	
Art.No	VCH30
Voltage / Frequency	230V/50Hz
Motor power (w)	1200
Airflow (m³ / min)	≥1.8
Vacuum pressure (KPa)	16.5±1.5
Noise (LpA)	<70
Tank capacity (L)	30
Electrical cord Length (m)	2.3
Lifetime (H)	350
Protection class	IPX4
New weight	9.5Kg

Power socket for electro portable tool max. 2,000W

Manufacturer reserves the right to change specifications without notice. Specifications may differ from country to country



Hose Tube



Wet Use Floor Brush
For also sucking water



Carpet Floor Brush
For carpet use



Sofa Brush
For curtains and furnitures



Round Brush
For sawdust etc.



Crevice Nozzle
For corners, cracks etc.



HEPA Filter



Plastic Connection Parts

CONCRETE GRINDER

Concrete Grinder

- ▲ Made of durable aluminum alloy, metal and engineering nylon
- ▲ Ergonomic design characterized with the increased balance and flatness
- ▲ Suitable for almost all 180mm diamond or resin discs
- ▲ Featured with power-off & overloading protections, and speed regulation
- ▲ Full wave electronics, soft start, and with a start-current limit function
- ▲ Removable front protective cover with magnetic, convenient for corner grinding (inner corner)
- ▲ Self-cleaning design, equipped with professional vacuum cleaner interface, can be used in vacuum bag or vacuum cleaner, dust-free operation
- ▲ Removing old surfaces as well as preparing a new base for secondary renovation
- ▲ Suitable for materials like tile, concrete, etching, tile adhesive, natural stone, plaster, paint, coating, adhesive carpet etc.

Technical Data	
Art.No	CG1900
Output	1900W
Voltage	230V/50Hz
Speed	0-3000RPM
Cup Wheel	180mm



180mm Diamond or resin discs



Protective cover with magnetic



Dust-free brush



Connection pipe to vacuum cleaner



Constant speed and soft start

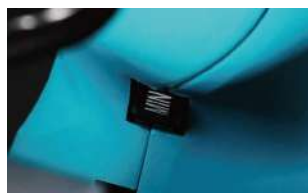

Variable speed switch

Working Stand for Concrete Grinder

- ▲ Working stand with 1.0-1.2M adjustable height and ergonomic handles
- ▲ With 2.5M cable, switch box and universal wheels and positioner device
- ▲ Suitable for BIHUI 1900W Concrete Grinder
- ▲ Save labor and energy when polishing or grinding large areas surfaces

Art.No	Size
CGWS19	1.0-1.2M



CUP WHEELS



Arrow Cup Wheel

- ▲ Arrow segment design for aggressive and fast material removal as well as surface preparation
- ▲ Features with large air holes designed to aid in and maintain a cool stable cutting pattern and reduced wear
- ▲ Suitable for grinding and smoothing materials like concrete, granite, sandstone and building material as well as adhesive, epoxy and paint removal

Art.No	Ø	Ø	MAX RPM	
DCWA5	125mm	5"	22.23mm	12250
DCWA7	175mm	7"	22.23mm	8500



Fan Cup Wheel

- ▲ Turbo fan design for aggressive and fast material removal as well as surface preparation
- ▲ Features with large air holes designed to aid in and maintain a cool stable cutting pattern and reduced wear
- ▲ Suitable for grinding and smoothing materials like concrete, granite, sandstone and building material

Art.No	Ø	Ø	MAX RPM	
DCWF5	125mm	5"	22.23mm	12250
DCWF7	175mm	7"	22.23mm	8500



Turbo Cup Wheel

- ▲ Spiral turbo design for aggressive and fast material removal as well as surface preparation
- ▲ Features with large air holes designed to aid in and maintain a cool stable cutting pattern and reduced wear
- ▲ Suitable for grinding, smoothing and for removing of adhesives and materials from concrete, granite, sandstone and building material

Art.No	Ø	Ø	MAX RPM	
DCWT5	125mm	5"	22.23mm	12250
DCWT7	180mm	7"	22.23mm	8500



Dual-Row Cup Wheel

- ▲ Double row design for aggressive and fast material removal as well as surface preparation
- ▲ Features with air holes designed to aid in and maintain a cool stable cutting pattern and reduced wear
- ▲ Suitable for grinding, smoothing and for removing of adhesives and materials from concrete, granite, sandstone and building material

Art.No	Ø	Ø	MAX RPM	
DCWD5	125mm	5"	22.23mm	12250
DCWD7	180mm	7"	22.23mm	8500





5" Variable Speed Angle Grinder

- ▲ With constant speed soft start
- ▲ Spindle Thread M14
- ▲ 6 variable gears from 3,000-11,000RPM
- ▲ With 3M cord and power-off protection
- ▲ 2-position TPR side handle
- ▲ Includes wrench, guard, side handle, carbon brushes



Technical Data	
Art.No	AG1200
Output	1200W
Voltage	230V/50Hz
Speed	3000-11000RPM

Suitable for Drilling, Cutting and Polishing



Vacuum Brazed Coating & Glue Grinding Cup Wheel

- ▲ Spiked diamonds for aggressive and fast material removal as well as surface preparation
- ▲ Features with air holes designed to aid in and maintain a cool stable cutting pattern and reduced wear
- ▲ Reinforced compound technology with high durability against impact and abrasion
- ▲ Suitable for removing epoxy, adhesive residues, paint coatings etc. from concrete, granite, sandstone and building material



Art.No	Ø	Ø	MAX RPM	
DCWG5	125mm	5"	22.23mm	12250

Grinding Dust Extractor

- ▲ Better health and less cleaning due to dust-free grinding
- ▲ Universal vacuum cleaner connection: diam 25-35 mm
- ▲ Brush rim largely prevents the leakage of fine dust
- ▲ Adjustable front part allows edge work
- ▲ Adjustable snap closure for secure mounting on the angle grinder



Art.No	Size
DCWDE5	100-125mm
DCWDEB	Spare brush



WITHOUT DUST EXTRACTOR GRINDING

CONNECTS EASY TO A VACUUM CLEANER

WITH DUST EXTRACTOR GRINDING

Multi-Purpose Dust Box

- ▲ Suitable for drilling and cutting
- ▲ Dust hole connecting with vacuum machine
- ▲ Dust trash door underneath
- ▲ Soft handle for easy carry
- ▲ Light weight and solid structure

Art.No	Size
TDB	500x350x62mm

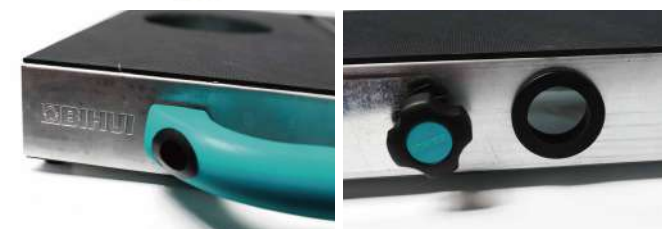

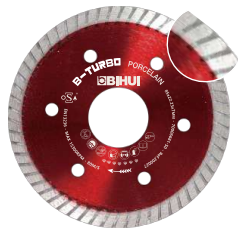

Diamond Blade

- ▲ Full 7mm height continuous diamond rim
- ▲ Suitable for cutting Hard Tiles , Marble , Slim Slab etc



Art.No				
DCDT85	85mm	3-3/8"	22.23mm	7



Diamond Blade

- ▲ Full 7mm height continuous diamond rim
- ▲ Central bore reinforced with 55mm double flange
- ▲ Suitable for cutting Hard Tiles , Marble , Slim Slab etc



Art.No				
DCDT115	115mm	4-1/2"	22.23mm	7
DCDT125	125mm	5"	22.23mm	7



Diamond Blade

- ▲ Full 7mm height continuous diamond rim
- ▲ Central bore reinforced with 70mm double flange
- ▲ Suitable for cutting Hard Tiles , Marble , Slim Slab etc



Art.No				
DCDT200	200mm	8"	25.4mm - 22.23mm	7
DCDT230	230mm	9"	22.23mm	7

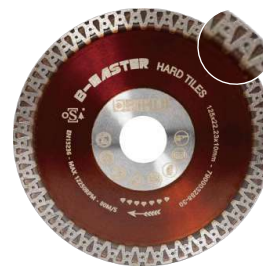

Diamond Blade

- ▲ Full 10mm height continuous diamond rim
- ▲ Central bore reinforced with 55mm double flange
- ▲ Suitable for cutting Hard Tiles , Porcelain tiles , Ceramic tiles etc



Art.No				
DCDA115	115mm	4-1/2"	22.23mm	10
DCDA125	125mm	5"	22.23mm	10



Diamond Blade

- ▲ Full 7mm height continuous diamond rim
- ▲ Central bore reinforced with 70mm double flange
- ▲ Suitable for cutting Slim Slab , Porcelain Tiles , Ceramic Tiles etc



Art.No				
DCDS115	115mm	4-1/2"	22.23mm	7
DCDS125	125mm	5"	22.23mm	7



Diamond Blade

- ▲ Full 10mm height continuous diamond rim
- ▲ Central bore reinforced with 55mm double flange
- ▲ Suitable for cutting Porcelain, Marble, Slim Slab



Art.No				
DCDW115	115mm	4-1/2"	22.23mm	10
DCDW125	125mm	5"	22.23mm	10

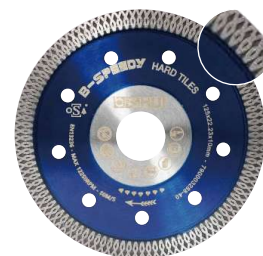

Diamond Blade

- ▲ Full 10mm height continuous diamond rim
- ▲ Central bore reinforced with 55mm double flange
- ▲ Suitable for cutting Hard Tiles , Porcelain Tiles , Ceramic Tiles etc



Art.No				
DCDM115	115mm	4-1/2"	22.23mm	10
DCDM125	125mm	5"	22.23mm	10



Diamond Blade

- ▲ Full 10mm height continuous diamond rim
- ▲ Suitable for cutting Mosaic Tiles, Glass mosaic, Stone mosaic etc



Art.No				
DCDC115	115mm	4-1/2"	22.23mm	10
DCDC125	125mm	5"	22.23mm	10

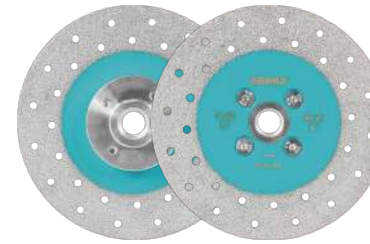

Vacuum Brazed Diamond Cutting and Grinding Wheel

- ▲ Designed for bevelling, small cuts, grinding, rounding and shaping edges and corners
- ▲ Can be used with any standard grinder, No adaptors needed
- ▲ Suitable for materials like porcelain, marble and granite etc.

Art.No			MAX RPM	
DCWMM115A	115mm	4-1/2"	5/8"-11	13200
DCWMM5	125mm	5"	M14	12250



Diamond Blade

- ▲ Full 12mm height rim with four special "W"
- ▲ Thick 2.4mm body for universal cutting purpose
- ▲ Suitable for cutting Granite, Stone and Hard Bricks etc.

Art.No				
DCDF115	115mm	4-1/2"	22.23mm	12



Diamond Blade

- ▲ Full 12mm height rim with four special "W"
- ▲ Thick 2.4mm body for universal cutting purpose
- ▲ Suitable for cutting Granite, Stone and Hard Bricks etc.

Art.No				
DCDF125	125mm	5"	22.23mm	12



Diamond Blade

- ▲ Full 12mm height rim with four special "W"
- ▲ Thick 2.4mm body for universal cutting purpose
- ▲ Suitable for cutting Granite, Stone and Hard Bricks etc.

Art.No				
DCDF230	230mm	9"	22.23mm	12



Electroplated Diamond Cutting and Grinding Wheel

- ▲ Designed for bevelling, small cuts, grinding, rounding and shaping edges and corners
- ▲ Can be used with any standard grinder, No adaptors needed
- ▲ Suitable for materials like porcelain, marble and granite etc.

Art.No			MAX RPM	
DCWME115A	115mm	4-1/2"	5/8"-11	13200
DCWME5	125mm	5"	M14	12250

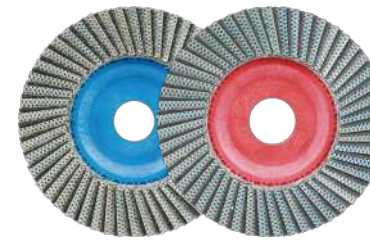

Universal Diamond Grinding Flap Wheel

- ▲ Spiral turbo design for aggressive and fast grinding
- ▲ Durable diamond and silicon carbide flaps
- ▲ Bore size 22.23, suitable for most angle grinder
- ▲ Suitable for grinding and smoothing materials like porcelain, marble and granite etc

Art.No		Grit	MAX RPM	
DPF060	115mm	4-1/2"	#60	10500
DPF200	115mm	4-1/2"	#200	10500

NEW

Mini Diamond Blade

- ▲ For fast and precise cutting with great adaptability
- ▲ Ideal for cutting ceramic tiles, porcelain, marble and stone

Art.No				
DCW50	50mm	2"	M14	6





AUTHORIZED
X-LOCK



Cyclone Diamond Blade

- ▲ Dry cutting depth upto 20mm
- ▲ Reinforced flange & Long lifetime
- ▲ Fine cuts and less dust
- ▲ Suitable for Tiles, marble, natural and artificial stone



Art.No					
DCBM115	115mm	4-1/2"	22.23mm	10	
DCBM5	125mm	5"	22.23mm	10	

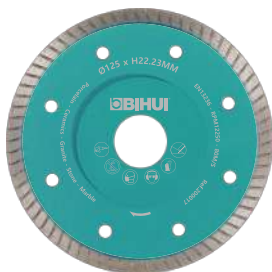

Super Thin Turbo Diamond Blade

- ▲ Dry cutting depth upto 20mm
- ▲ Reinforced flange & Long lifetime
- ▲ Fine cuts and less dust
- ▲ Suitable for Tiles, marble, natural and artificial stone



Art.No					
DCBT115	115mm	4-1/2"	22.23mm	7.5	
DCBT5	125mm	5"	22.23mm	7.5	

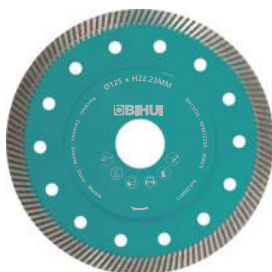

Super Narrow Teeth Diamond Blade

- ▲ Dry cutting depth upto 20mm
- ▲ Reinforced flange & Long lifetime
- ▲ Fine cuts and less dust
- ▲ Suitable for Tiles, marble, natural and artificial stone



Art.No					
DCBN115	115mm	4-1/2"	22.23mm	10	
DCBN5	125mm	5"	22.23mm	10	

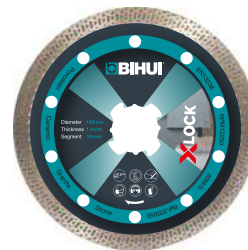

Wave Rim Diamond Blade

- ▲ Cutting depth 25mm
- ▲ Central bore designed with X-LOCK
- ▲ Suitable for cutting Hard Tiles, Porcelain tiles, Ceramic tiles etc

Art.No	Size	
DCXW115	115mm	4-1/2"
DCXW125	125mm	5"



Continuous Rim Diamond Blade

- ▲ Cutting depth 25mm
- ▲ Central bore designed with X-LOCK
- ▲ Suitable for cutting Hard Tiles, Porcelain tiles, Ceramic tiles etc

Art.No	Size	
DCXC115	115mm	4-1/2"
DCXC125	125mm	5"

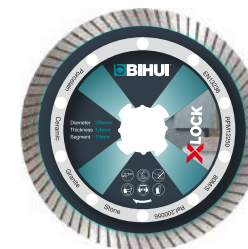

Super Thin Turbo Diamond Blade

- ▲ Cutting depth 25mm
- ▲ Central bore designed with X-LOCK
- ▲ Suitable for cutting Hard Tiles, Porcelain tiles, Ceramic tiles etc

Art.No	Size	
DCXT115	115mm	4-1/2"
DCXT125	125mm	5"



X-LOCK Diamond Dry Drill Bit

- ▲ Compatible with X-LOCK angle grinders
- ▲ Can be changed quickly and conveniently
- ▲ Suitable for drilling porcelain, marble and granite
- ▲ Available in different sizes

Art.No	Size	Art.No	Size	Art.No	Size
DBXL10	10mm 3/8"	DBXL35	35mm 1-3/8"	DBXL50	50mm 2"
DBXL20	20mm 3/4"	DBXL40	40mm 1-5/8"	DBXL68	68mm 2-5/8"





-  SUITABLE FOR PORCELAIN & HARD TILES
-  USE DRY
-  USE WITH ANGLE GRINDER 11000 RPM
-   



1. Start drill at a 45° angle to the surface until good contact has been established.

2. Proceed drilling in a circular motion until the hole is done.



Diamond Turbo Drill Set

4pcs

- ▲ Vacuum brazed diamond drill bit
- ▲ M14 connection to angle grinder
- ▲ Fast speed and long lifetime
- ▲ Drills in size Ø25x74, Ø40x74, Ø60x74, Ø70x74mm

Art.No	Size
DBDMK4	4pcs Set



Diamond Turbo Drill Set

7pcs

- ▲ Vacuum brazed diamond drill bit
- ▲ Vacuum brazed diamond grinding bit
- ▲ M14 connection to angle grinder
- ▲ Fast speed and long lifetime
- ▲ Drill in size 25x74, 35x74, 40x74, 45x74, 68x74mm
Finger bit in 20mm & cone bit in 20-48mm

Art.No	Size
DBDMS7	7pcs Set



Diamond Turbo Drill Set

5pcs

- ▲ Vacuum brazed diamond drill bit
- ▲ M14 connection to angle grinder
- ▲ Hexagon adaptor for electric drill
- ▲ Fast speed and long lifetime
- ▲ Drills in size Ø6x64, Ø8x64, Ø10x64, Ø12x64mm & Adaptor

Art.No	Size
DBDMK5	5pcs Set



Diamond Turbo Drill Set

10pcs

- ▲ Vacuum brazed diamond drill bit
- ▲ M14 connection to angle grinder
- ▲ Fast speed and long lifetime
- ▲ Drill in size 25x74, 35x74, 40x74, 45x74, 50x74, 68x74mm
- ▲ Finger bit in 20mm & cone bit in 20-48mm
- ▲ Cutting disc in 125mm & cooling gel

Art.No	Size
DBDMS10	10pcs Set

-  SUITABLE FOR PORCELAIN & HARD TILES
-  USE DRY
-  USE WITH ANGLE GRINDER 11000 RPM

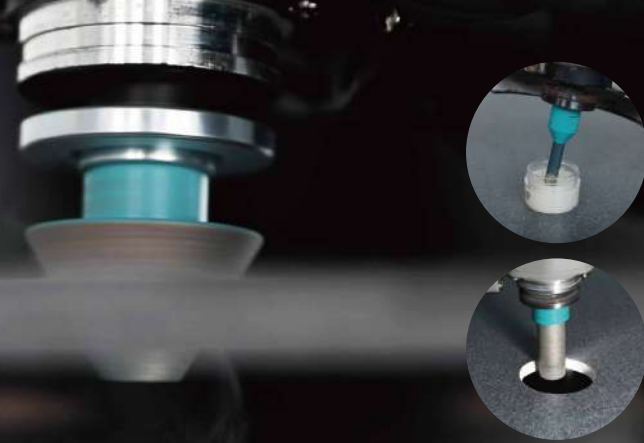

Diamond Mill

- ▲ Medium grit
- ▲ Suggested MIN RPM 1500
- ▲ For enlarge or polishing holes after drilling

Art.No	Size	Thread
DMB10	10mm 3/8"	M14
DMB10A	10mm 3/8"	5/8"-11



Diamond Mill

- ▲ Medium grit
- ▲ Suggested MIN RPM 1500
- ▲ For enlarge or polishing holes after drilling

Art.No	Size	Thread
DMB20	20mm 3/4"	M14
DMB20A	20mm 3/4"	5/8"-11



Drill Chuck Adaptor

- ▲ For converting M14 thread into hexagon connection for drill machine
- ▲ Suggested MIN RPM 2500

Art.No	Size
DBAMH	M14-Hexagon



Turbo Dry Drill Bit

- ▲ Vacuum brazed diamond drill bit
- ▲ M14 or 5/8"-11 thread to angle grinder
- ▲ Fast speed and long lifetime
- ▲ Suggested RPM 11000
- ▲ Suitable for drilling porcelain, marble and granite

Art.No	Size	
	mm	inch
DBDF06	6mm	1/4"
DBDF08	8mm	5/16"
DBDF10	10mm	3/8"
DBDF12	12mm	1/2"
DBDF20	20mm	3/4"
DBDF28	28mm	1-1/8"
DBDF35	35mm	1-3/8"
DBDF40	40mm	1-5/8"
DBDF55	55mm	2-3/16"
DBDF60	60mm	2-3/8"
DBDF68	68mm	2-5/8"
DBDF75	75mm	3"
DBDF100	100mm	4"
DBDF115	115mm	4-1/2"

More sizes available



Diamond Mill

- ▲ Medium grit, Conical top
- ▲ Suggested MIN RPM 1500
- ▲ For enlarge or polishing holes after drilling

Art.No	Size	Thread
DMC238	2-38mm	M14
DMC238A	2-38mm	5/8"-11



Diamond Mill

- ▲ Medium grit, Flat top
- ▲ Suggested MIN RPM 1500
- ▲ For enlarge or polishing holes after drilling

Art.No	Size	Thread
DMF2048	20-48mm	M14
DMF2048A	20-48mm	5/8"-11



Cooling Wax

- ▲ 20-25ml
- ▲ For cooling tile drill bit
- ▲ Prolonger lifetime and drilling speed

Art.No	Size
DBCW20	20-25ml

Material	1	2	3	4	5
Porcelain	Shaded	Shaded	Shaded	Shaded	Shaded
Marble	Shaded	Shaded	Shaded	Shaded	Shaded
Travertine	Shaded	Shaded	Shaded	Shaded	Shaded
Granite	Shaded	Shaded	Shaded	Shaded	Shaded
Ceramic	Shaded	Shaded	Shaded	Shaded	Shaded

Lifetime

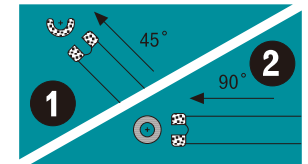

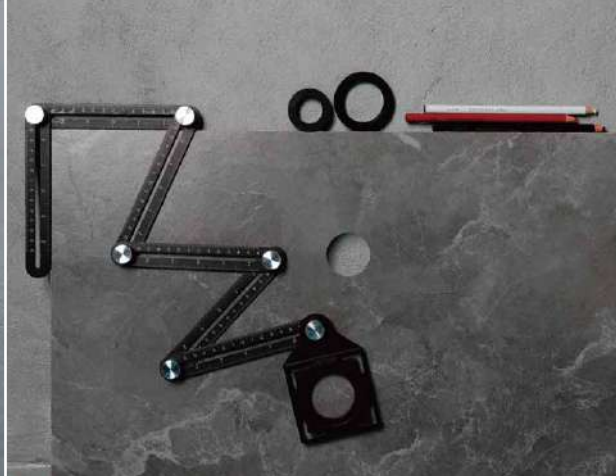

Hexagon Connection Diamond Dry Drill Bit

- ▲ Hexagon shaft to fit drill machine
- ▲ Fast speed and long lifetime
- ▲ Suggested RPM 2500
- ▲ Suitable for drilling porcelain, marble and granite



Art.No	Size	
DBDH06	6mm	1/4"
DBDH08	8mm	5/16"
DBDH10	10mm	3/8"
DBDH12	12mm	1/2"
DBDH14	14mm	9/16"
DBDH20	20mm	3/4"



More sizes available

Quick Change Diamond Dry Drill Bit

- ▲ Quick clip handle to shaft drill
- ▲ Fast speed and long lifetime
- ▲ Suggested RPM 2500
- ▲ Suitable for drilling porcelain, marble and granite



Art.No	Size	
DBDQ06	6mm	1/4"
DBDQ08	8mm	5/16"
DBDQ10	10mm	3/8"
DBDQ12	12mm	1/2"
DBDQ14	14mm	9/16"
DBDQ20	20mm	3/4"



More sizes available

Porcelain				
Marble				
Travertine				
Granite				
Ceramic				



Drill Guide Master

- ▲ Integrated water hole attach to cooling system for wet drilling
- ▲ For guiding hole saw drill from 4mm to 115mm
- ▲ Fixed hole size in 4,5,6,7,8,10,12,20,35mm
- ▲ Adjustable steel plate with maximum opening length 80mm
- ▲ For 81mm to 115mm drills, place the drills at the end of the guide
- ▲ Loose the screw, suction cup can be used individually with max. capacity of 35Kg (77lbs)
- ▲ Suction cup suitable for Tiles, Glass, Marble, Granite, etc.

Art.No	Size
DBGM	Universal



Universal Guide

- ▲ High quality suction pad for hole locating
- ▲ Integrated with steel plate for precise drilling
- ▲ ABS material with comfort nylon handle
- ▲ Suitable for drill sizes in 4,5,6,8,10,12,14mm

Art.No	Size
DBGU	Universal



Tile Drill Guide

- ▲ Made of stainless steel
- ▲ Durable suction rubber pad
- ▲ Suitable for drills from 6-40mm

Art.No	Size
DBGV	Universal



Multi-Functional Adjustable Tile Hole Locator

- ▲ Made of 2.5mm aluminum alloy material, durable and perfect thickness
- ▲ Laser calibration in both centimeters and inches, easy and simple
- ▲ Six-sided foldable arms with 360°freely fixing knobs
- ▲ Guide in 45mm,40mm and 25mm for drilling holes on tiles, glass, marble, granite etc.

Art.No	Size
DBG6	Universal



Electroplated Diamond Drill Bit

- ▲ Suitable for drilling porcelain, marble, granite, glass and travertine
- ▲ To maximize performance ensure drill is cooled with water



Art.No	Size	Art.No	Size
DBW06	6mm 1/4"	DBW45	45mm 1-3/4"
DBW08	8mm 5/16"	DBW50	50mm 2"
DBW10	10mm 3/8"	DBW55	55mm 2-3/16"
DBW12	12mm 1/2"	DBW68	68mm 2-5/8"
DBW20	20mm 3/4"	DBW75	75mm 3"
DBW25	25mm 1"	DBW100	100mm 4"
DBW35	35mm 1-3/8"	DBW120	120mm 4-3/4"



More sizes available

Diamond Hand Pad

- ▲ For wet & dry grinding edges and surfaces
- ▲ Suitable for tile, porcelain, marble and glass
- ▲ Use the entire diamond surface for the best results
- ▲ Size: 55 x 95mm

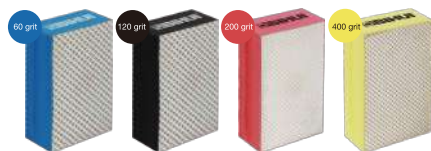

Art.No	Grit
DHP060	60#
DHP120	120#
DHP200	200#
DHP400	400#

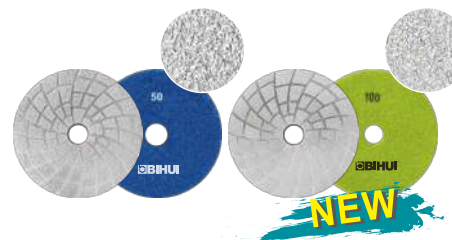
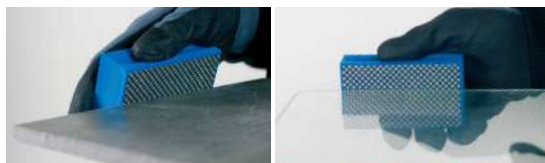

Vacuum Brazed Diamond Polishing Pad

- ▲ Aggressive and well finish
- ▲ Great for polishing flat surface and beveling edges
- ▲ Designed for tile, porcelain, marble and glass



Art.No	Size	Grit
DPV405	100mm (4")	#50
DPP410		#100

Polishing Pad Holder

- ▲ Velcro connection to polishing pads
- ▲ Rubber Backing with M14 or 5/8"-11 thread

Art.No	Size	Thread
DPPH4	100mm (4")	M14
DPPH4A		5/8"-11



Diamond Polishing Pads

- ▲ Sharp, durable, well finish
- ▲ Great for polishing flat surfaces and bevelled edges
- ▲ Light color pad design
- ▲ Specially ideal for white and light color ceramic tiles and other materials

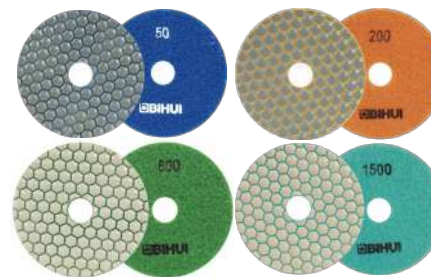

Art.No	Size	Grit
DPP405		#50
DPP410		#100
DPP420	100mm (4")	#200
DPP480		#800
DPP415		#1500

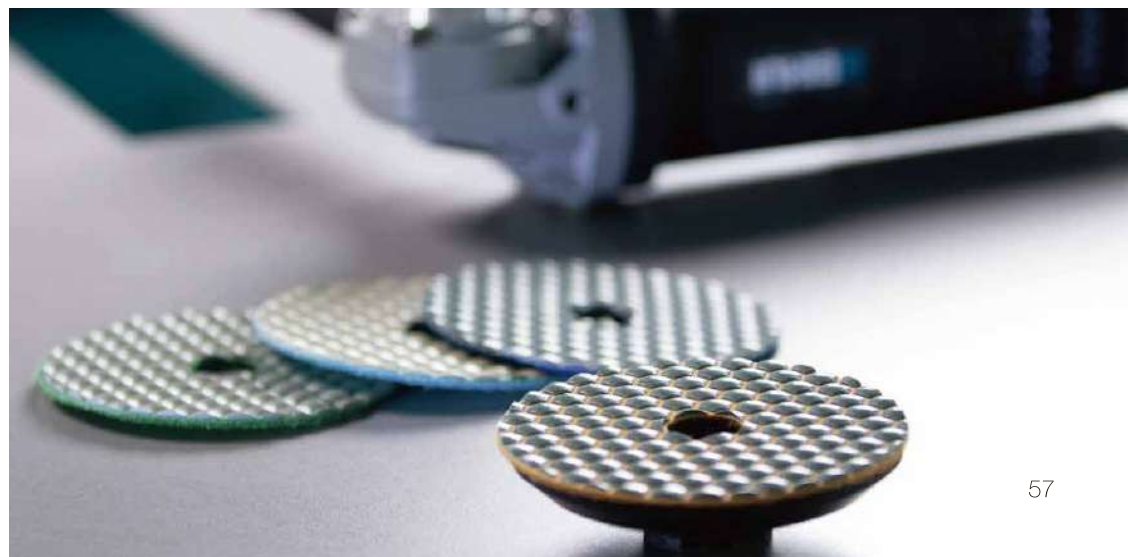



- BPG01 Travel Case
- BPG02 Coffee Mug
- BPG03 Short Shirt
- BPG04 Baseball Cap
- BPG05 Calendar
- BPG06 Travel Bag









 **BIHUI**[®]

www.bihuitools.com

Art.No: BPG08



6 970431 875512